

SUNSET FESTIVAL 2014

APPENDIX P SITE AND AREA PLANS

FOR LICENSE
APPLICATION 29/4/14

28th August to 1st
September

East Pidsley Farm
Pidsley Lane
Sandford
EX17 4EW

OS ref (2181633,105093)

Contents

1 INTRODUCTION.....	2
2 TRAFFIC MANAGEMENT.....	3
2.1 Traffic Management – Traffic from Crediton.....	3
2.2 Traffic Management – Site Close-up and Blue Light Access Routes.....	4
2.3 Map C Internal Traffic Management (to follow).....	5
2.4 Legend.....	6
3 FACILITIES AND SITE LAYOUT.....	7
4 DETAILED AREA PLANS (TO FOLLOW).....	8
4.1 Overview.....	8
4.2 Map F Main Arena Area Plan (including Market traders and Performance Areas).....	9
a) Main Performance Area.....	9
b) Healing Area and Reggae Stage.....	10
c) Kids Area and Acoustic Stage.....	11
d) Solar Area.....	12
5 DISCLAIMER.....	13

1 Introduction

This Appendix contains site and area plans detailing the layout of the site, traffic management strategy and the locations of key infrastructure. Please refer to the appropriate chapter within the EMP for additional information.

The image files for these maps are available accompanying this document.

2 Traffic Management

2.1 Traffic Management – Traffic from Crediton

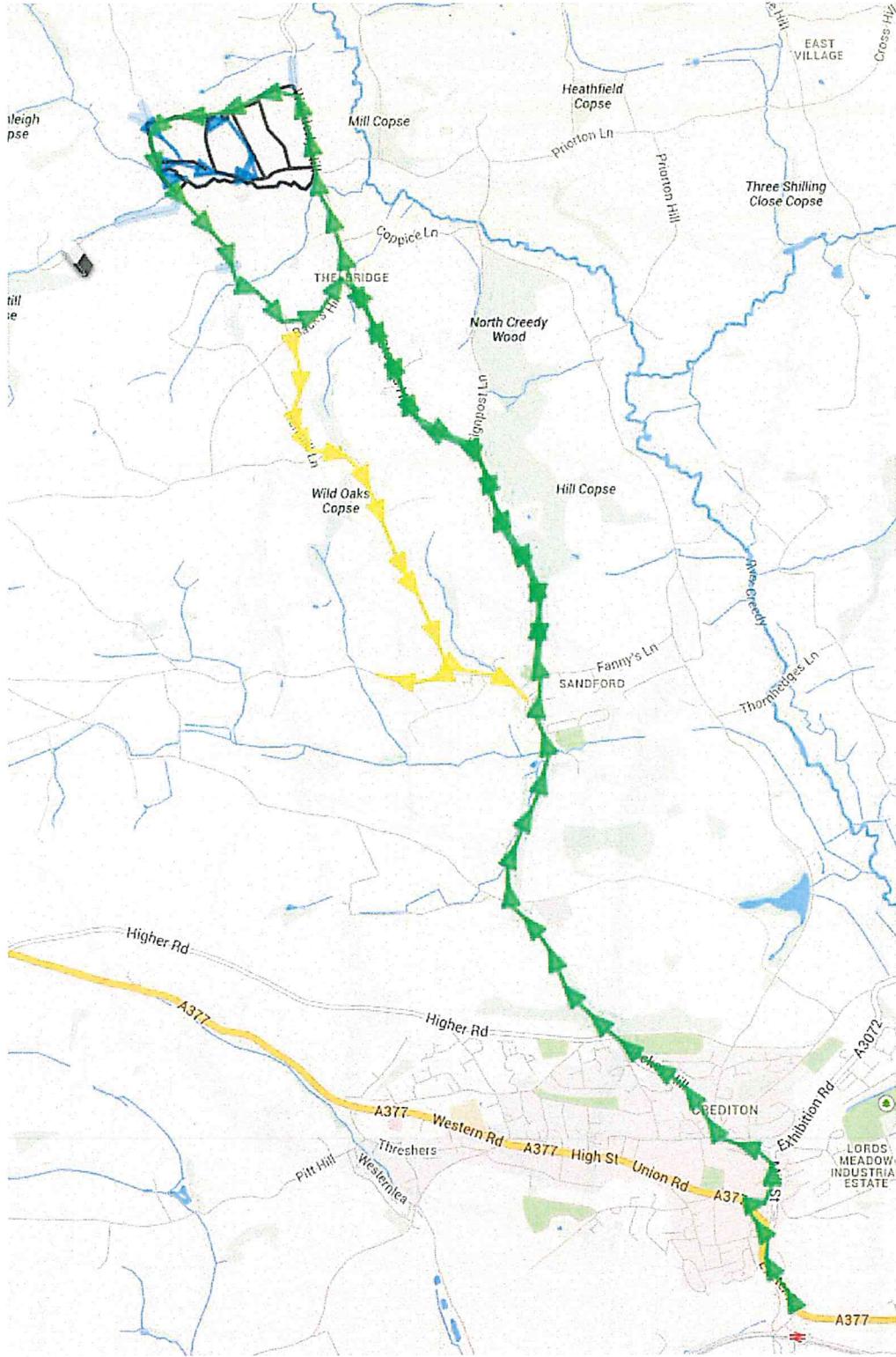

2.2 Traffic Management – Site Close-up and Blue Light Access Routes

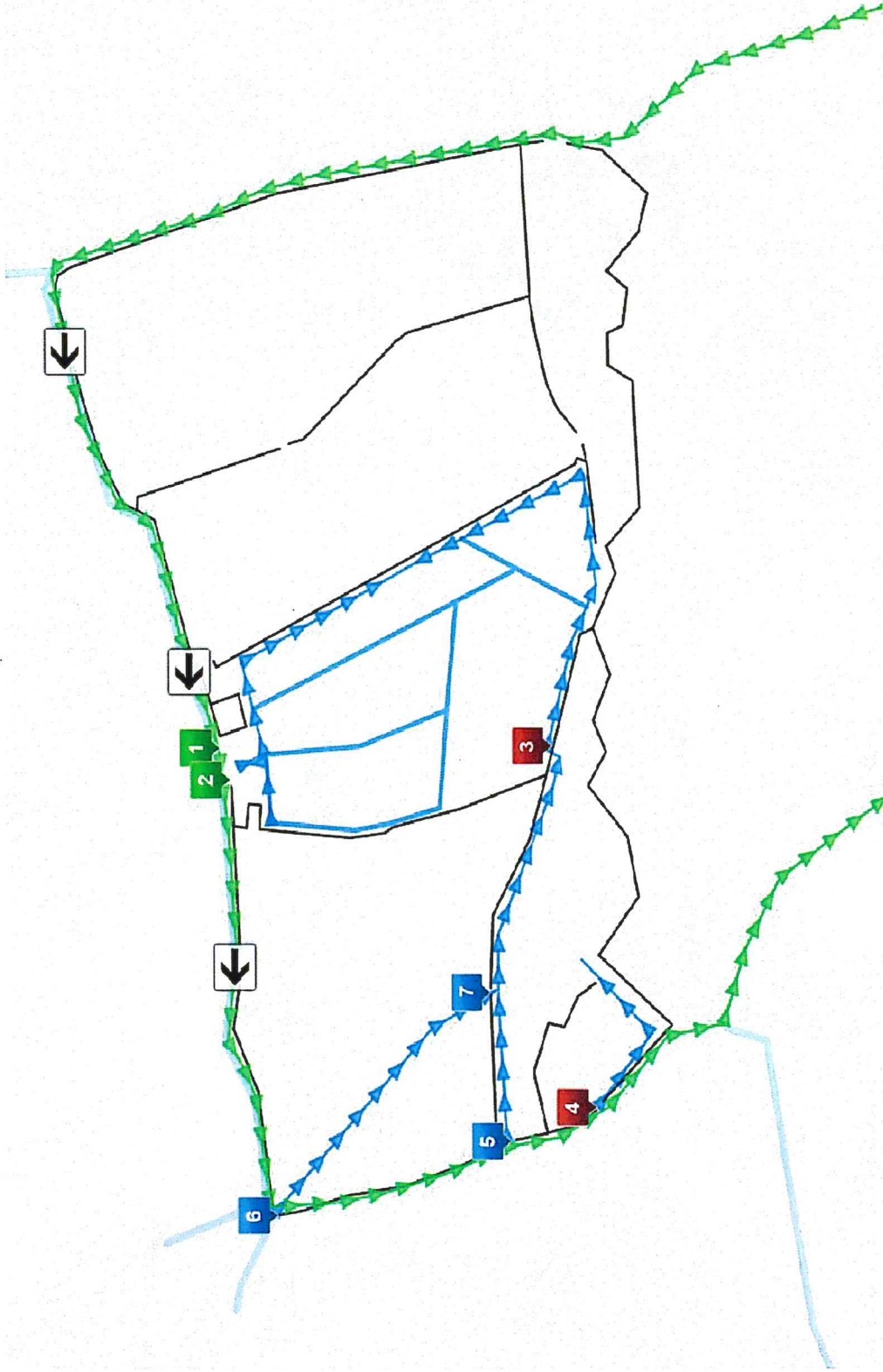

2.3 Map C Internal Traffic Management (to follow)

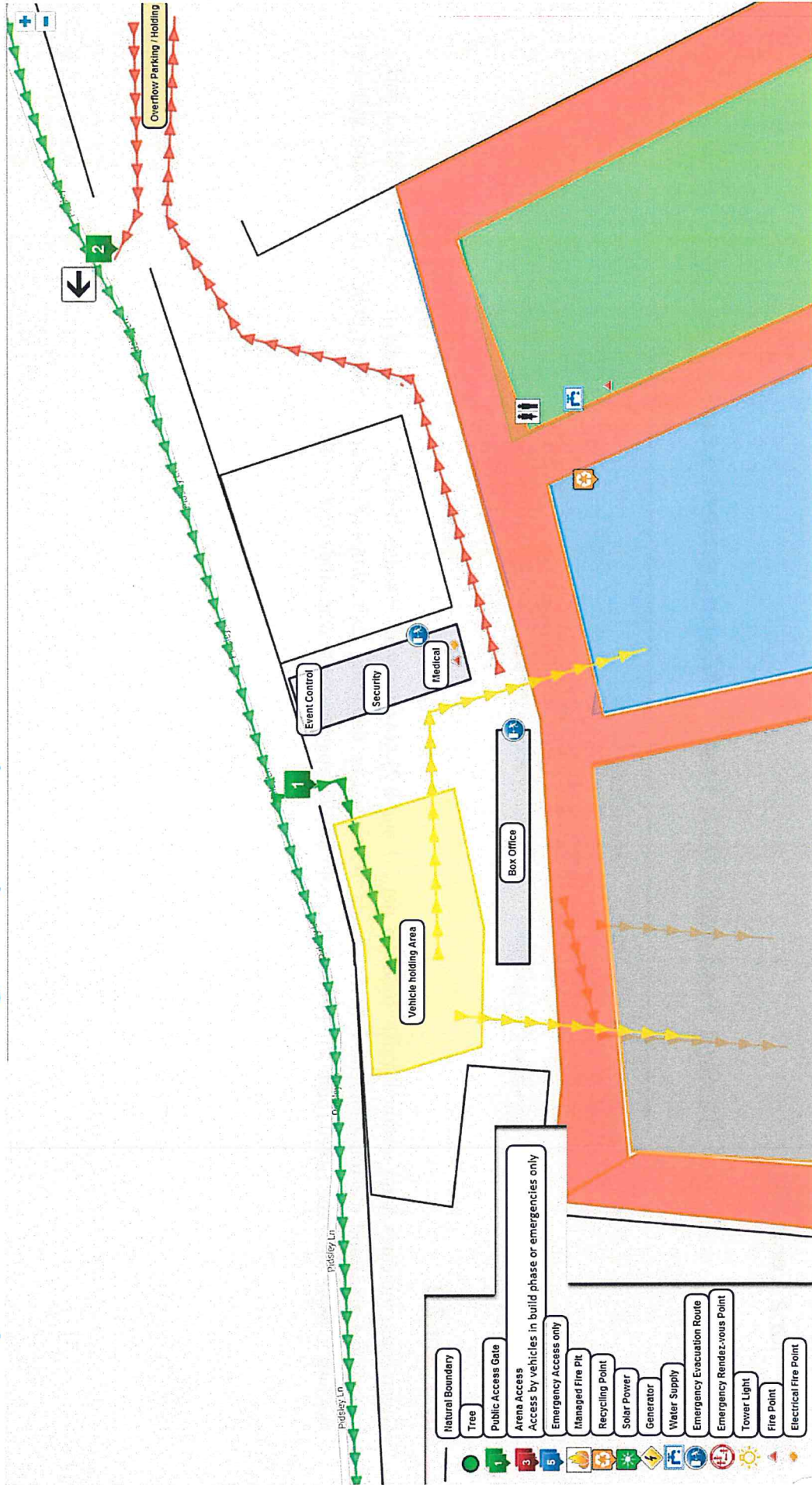

2.4 Legends

a) for 2.1 and 2.2

Sunset Festival 2014 Traffic Management Legend

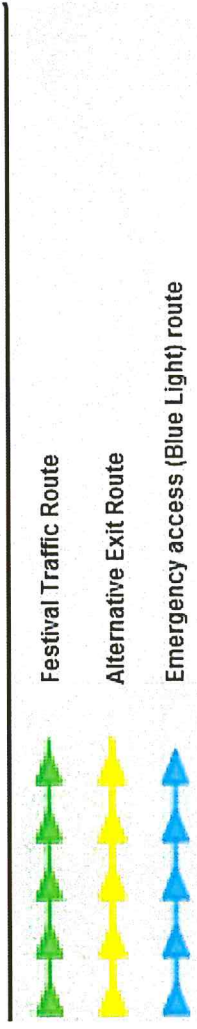

b) for 2.3

Green route indicates main festival traffic route (as per 2.1 and 2.2) however yellow routes indicate internal traffic on-site (toward car park / motorhome area) and red route indicates the exit route to be used by departing taxis, drop-offs, people without tickets or any other vehicles needing to leave site. The Green route will become the main traffic departure route when the event is over.

3 Facilities and Site Layout

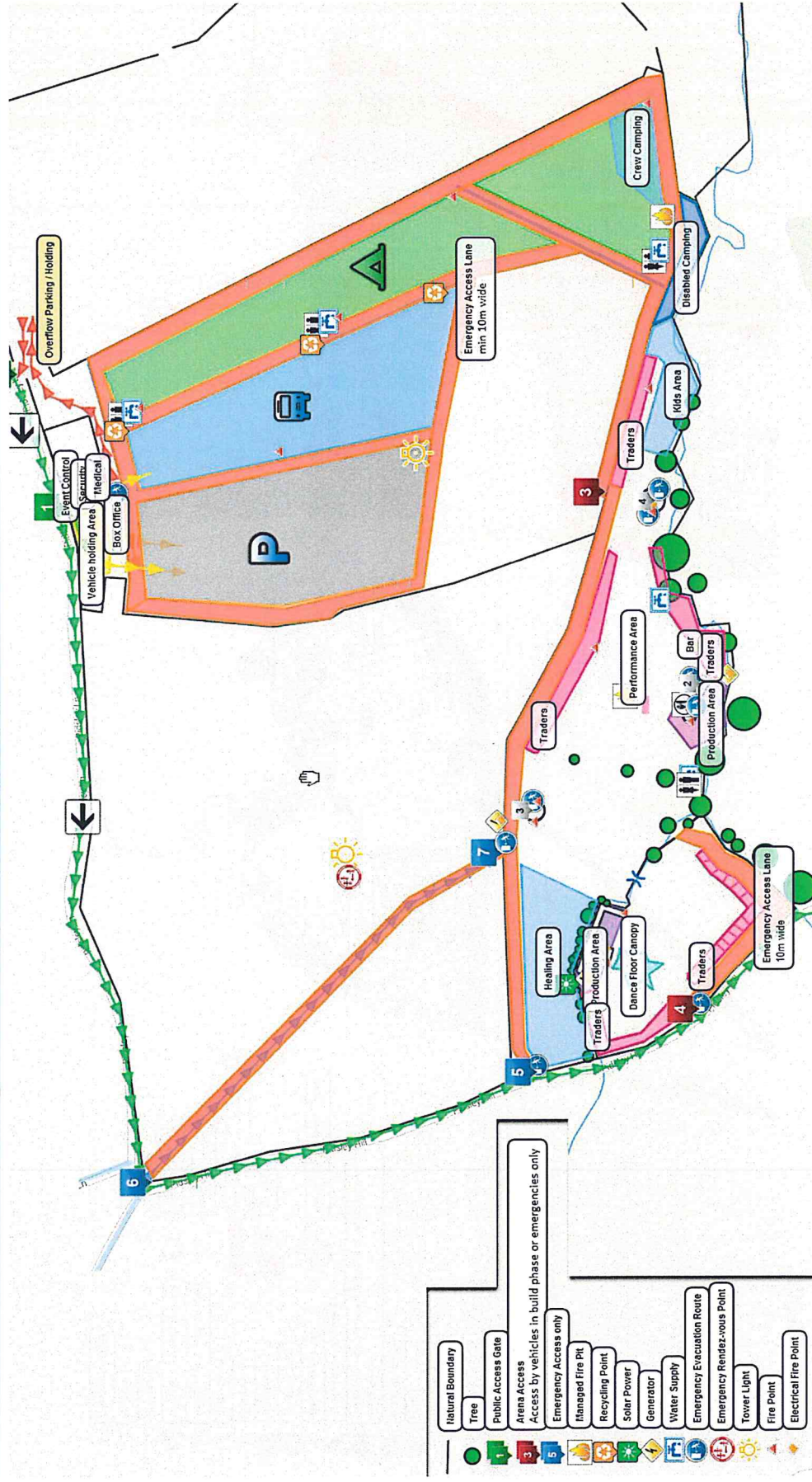

4.2 Map F Main Arena Area Plan (including Market traders and Performance Areas)

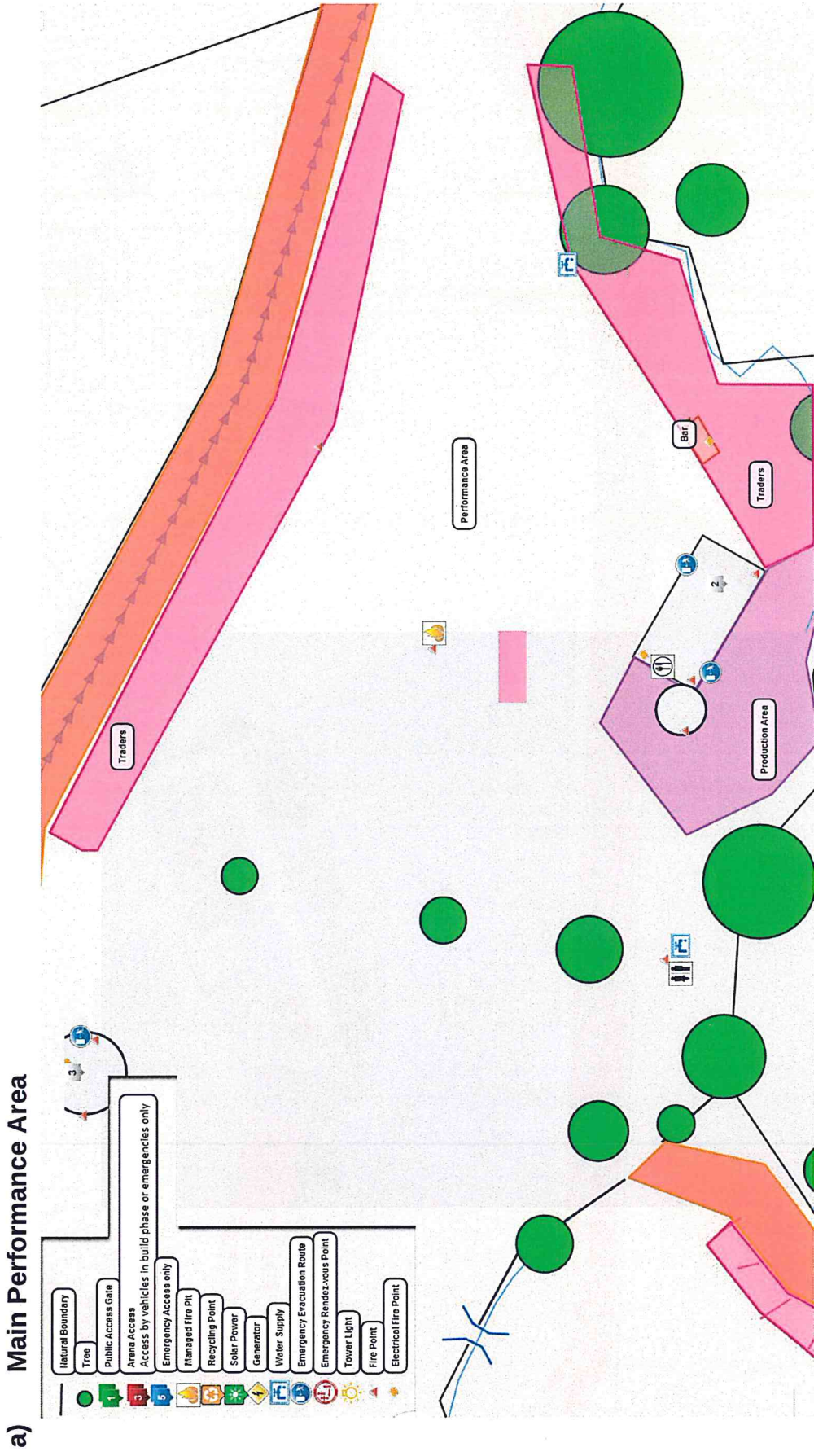

b) Healing Area and Reggae Stage

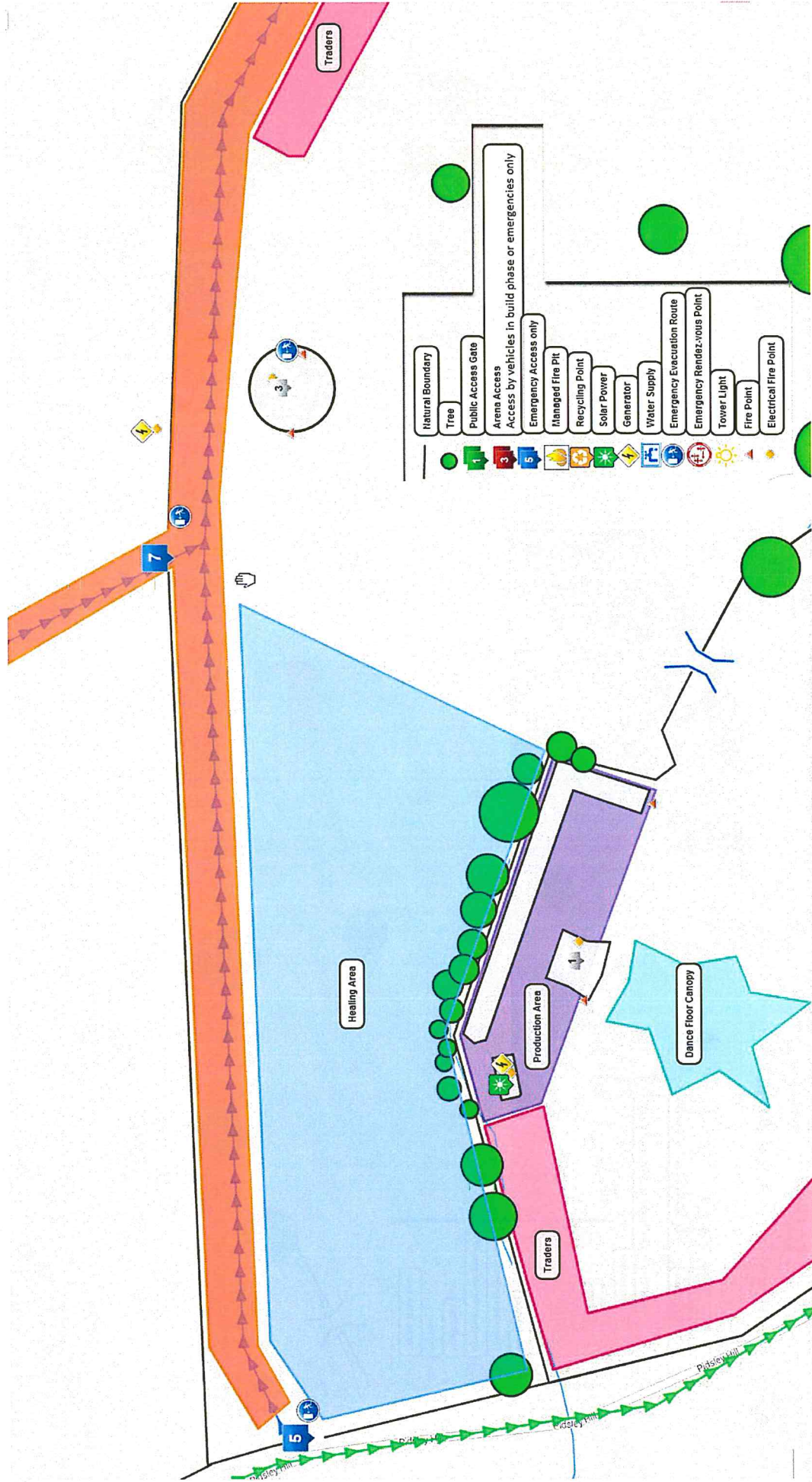

c) Kids Area and Acoustic Stage

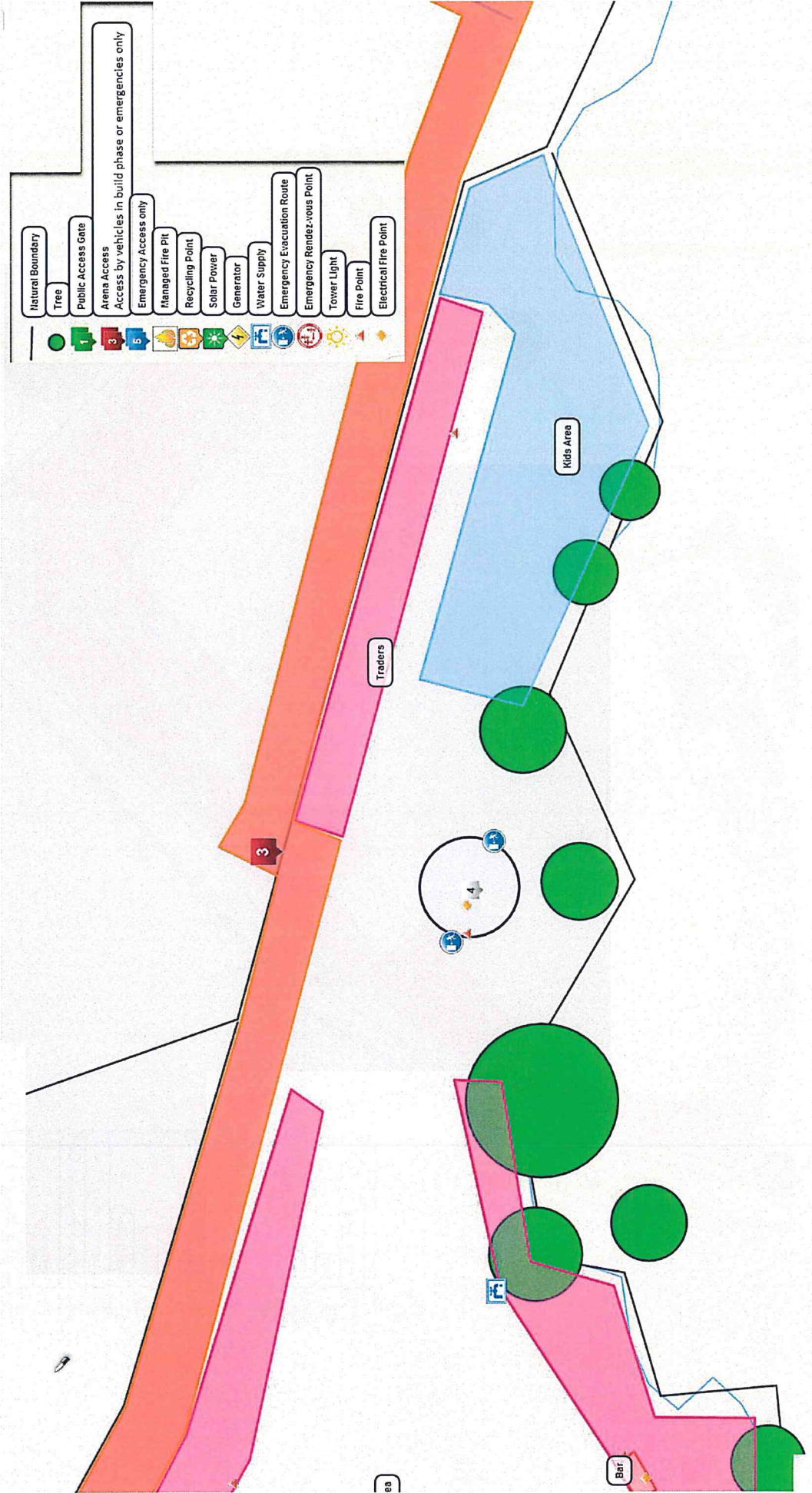

d) Solar Area

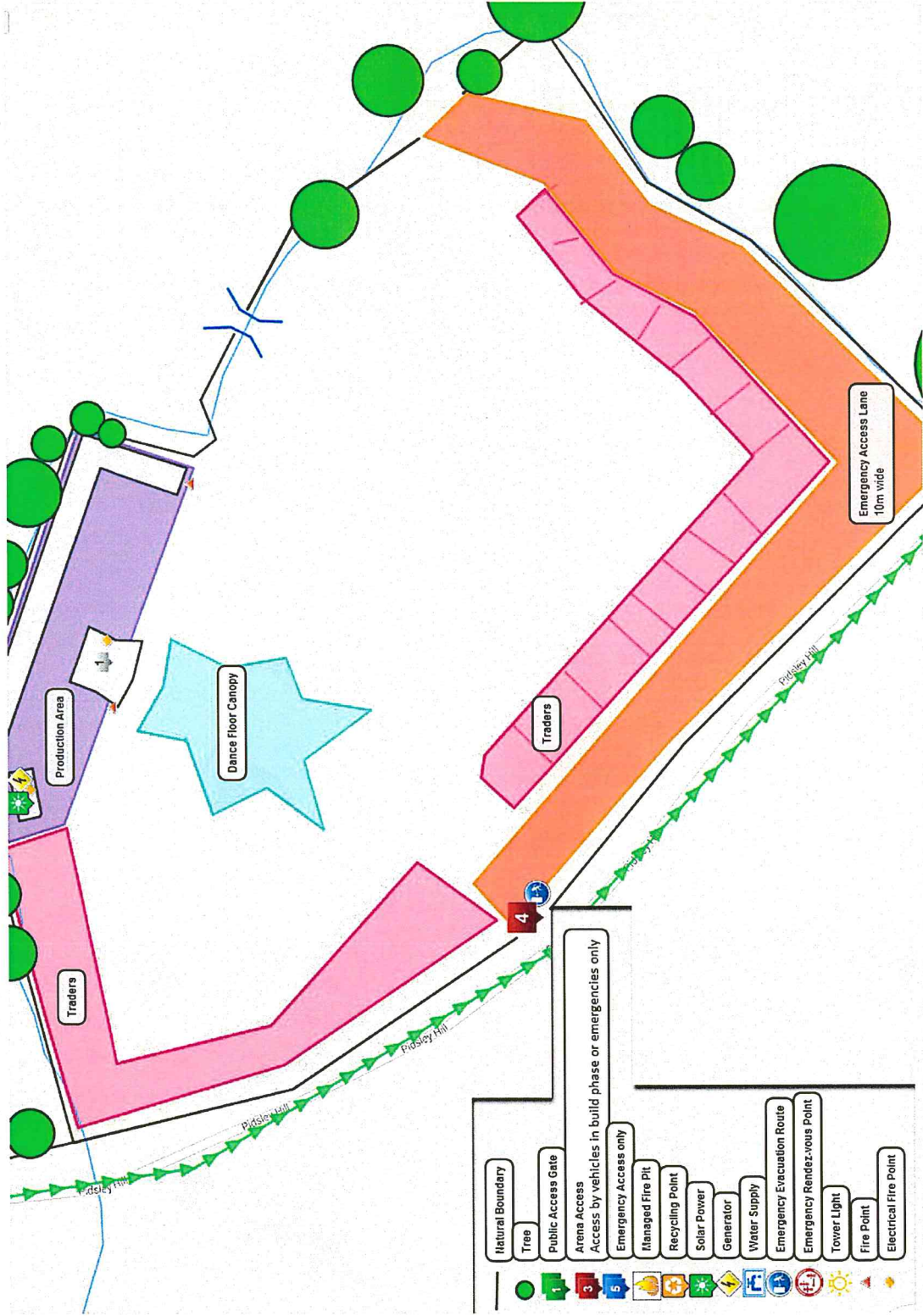

5 Disclaimer

The information contained in this document/record is proprietary to the organisers unless stated otherwise and is made available in confidence. It must not be used or disclosed without the express written permission of the organisers. This document/record may not be copied in whole or in part in any form without the express written consent of the organisers which may be given by contract.

The contents of this document are subject to change without notice, until the document is approved and agreed by all parties and released at Issue 1.

Date of issue	28/04/14
---------------	----------

